

Metric Grippers "EMCT"-Carbide Tipped

EMCT - ROUND								
CAD FILE NAME	PART NUMBER	A DIA	B	C	D	E	F TAP	TOOTH PATTERN
EMCT100	EMCT-100	10	10	4.5	4.75	7.9	M5 x 0.8	EX-FINE
EMCT102	EMCT-102	10	12	6	4.75	7.9	M5 x 0.8	EX-FINE
EMCT120	EMCT-120	12	10	4.5	4.75	9.5	M5 x 0.8	FINE
EMCT122	EMCT-122	12	12	6	4.75	9.5	M5 x 0.8	FINE
EMCT160	EMCT-160	16	10	4.5	4.75	12.7	M6 x 1.0	FINE
EMCT162	EMCT-162	16	12	6	4.75	12.7	M6 x 1.0	FINE
EMCT200	EMCT-200	20	10	4.5	4.75	15.9	M6 x 1.0	FINE
EMCT202	EMCT-202	20	12	6	4.75	15.9	M6 x 1.0	FINE
EMCT250	EMCT-250	25	10	4.5	4.75	19.0	M6 x 1.0	FINE
EMCT252	EMCT-252	25	12	6	4.75	19.0	M6 x 1.0	FINE
EMCT840EF	EMCT-840-EF	12.7	12.7	5.9	4.75	9.5	M6 x 1.0	EX-FINE
EMCT841EF	EMCT-841-EF	12.7	9.5	4.4	4.75	9.5	M6 x 1.0	EX-FINE
EMCT842EF	EMCT-842-EF	12.7	16.5	7.5	4.75	9.5	M6 x 1.0	EX-FINE
EMCT850EF	EMCT-850-EF	15.9	9.5	4.4	4.75	12.7	M6 x 1.0	EX-FINE
EMCT860EF	EMCT-860-EF	19.0	9.5	4.4	4.75	15.9	M6 x 1.0	EX-FINE
EMCT - SQUARE								
EMCT9120	EMCT-9120	12	10	-	-	10.3	M5 x 0.8	FINE
EMCT9122	EMCT-9122	12	12	-	-	10.3	M5 x 0.8	FINE
EMCT870EF	EMCT-870-EF	12.7	9.5	-	-	10.3	M6 x 1.0	EX-FINE
EMCT - ANGLE GRIP								
EMCT1274	EMCT-127-4	14.3	9.5	M5 x 0.8	11.9	-	-	4-POINT
EMCT12712	EMCT-127-12	14.3	9.5	M5 x 0.8	11.9	-	-	FINE
EMCT1304	EMCT-130-4	14.3	9.5	M5 x 0.8	11.9	-	-	STRAIGHT
EMCT1455	EMCT-145-5	14.3	9.5	M5 x 0.8	11.9	-	-	ANGULAR

*Optional tooth patterns available, must add "EF" for Extra-Fine to end of part number, otherwise gripper will be supplied with Fine tooth pattern.

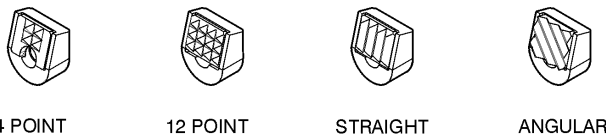

"EMCTH" CARBIDE TIPPED ADJUSTABLE							
CAD FILE NAME	PART NUMBER	A	B	C HEX	D	E THD.	TOOTH PATTERN
EMCTH06102	EMCTH-06102	12	5	10	7.9	M6 x 1.0	EX-FINE
	EMCTH-06100	25	5	10	7.9	M8 x 1.0	EX-FINE
EMCTH08122	EMCTH-08122	12	6.4	13	9.5	M8 x 1.25	FINE
	EMCTH-08125	25	6.4	13	9.5	M8 x 1.25	FINE
	EMCTH-08125x35	35	6.4	13	9.5	M8 x 1.25	FINE
EMCTH10125	EMCTH-10125	25	7.5	17	12.7	M10 x 1.25	FINE
	EMCTH-10125x40	40	7.5	17	12.7	M10 x 1.25	FINE
EMCTH10152	EMCTH-10152	12	8.3	17	12.7	M10 x 1.50	FINE
	EMCTH-10150	25	8.3	17	12.7	M10 x 1.50	FINE
	EMCTH-10150x40	40	8.3	17	12.7	M10 x 1.50	FINE
EMCTH12175	EMCTH-12175	25	8.7	19	15.9	M12 x 1.75	FINE
	EMCTH-12175x40	40	8.7	19	15.9	M12 x 1.75	FINE
EMCTH16200	EMCTH-16200	35	11	24	19.0	M16 x 2.00	FINE
	EMCTH-16200x50	50	11	24	19.0	M16 x 2.00	FINE
EMCTH20250	EMCTH-20250	40	13.7	30	25.4	M20 x 2.50	EX-FINE
	EMCTH-20250x60	60	13.7	30	25.4	M20 x 2.50	EX-FINE

"EMPG" CARBIDE TIPPED ADJUSTABLE						
CAD FILE NAME	PART NUMBER	A	B	C	INT HEX	TOOTH PATTERN
MPG10150	EMPG-10150	25	6.4	M10 x 1.50	5	EX-FINE
	EMPG-10150x50	50	6.4	M10 x 1.50	5	EX-FINE
MPG121754	EMPG-12175-4	25	7.9	M12 x 1.75	6	4-POINT
	EMPG-12175	25	7.9	M12 x 1.75	6	EX-FINE
MPG121754	EMPG-12175x50-4	50	7.9	M12 x 1.75	6	4-POINT
	EMPG-1217x50	50	7.9	M12 x 1.75	6	EX-FINE
MPG162004	EMPG-16200-4	25	11.1	M16 x 2.00	8	4-POINT
	EMPG-16200	25	11.1	M16 x 2.00	8	FINE
MPG162004	EMPG-16200x50-4	50	11.1	M16 x 2.00	8	4-POINT
	EMPG-16200x50	50	11.1	M16 x 2.00	8	FINE
MPG202504	EMPG-20250-4	25	12.7	M20x 2.50	10	4-POINT
MPG20250	EMPG-20250	25	12.7	M20x 2.50	10	FINE

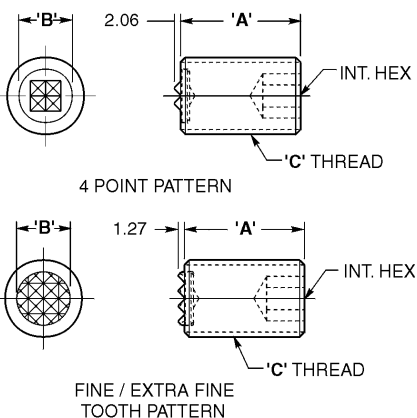
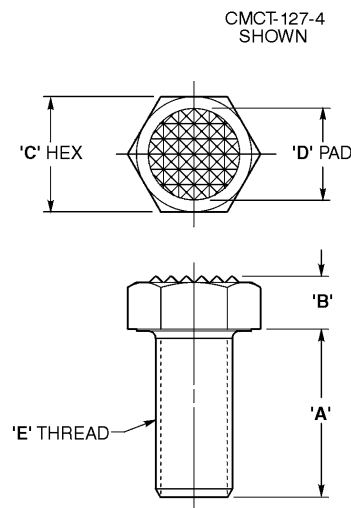
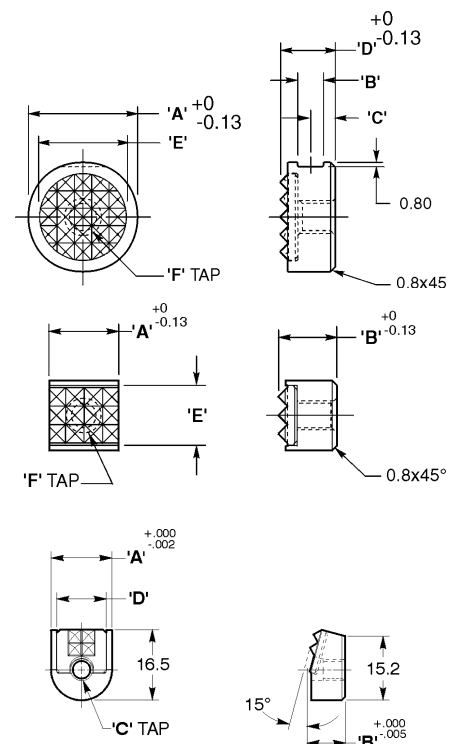

CAD Directory

Mach-Tool\Met-Gripper

Note: The shortest standard component is given, you may "stretch" the unit to the desired length.

All dimensions are in mm